

H HT SERIES HT230 SPECIFICATIONS

LIT NO: L29

DATE: January 2000

REVISION: A

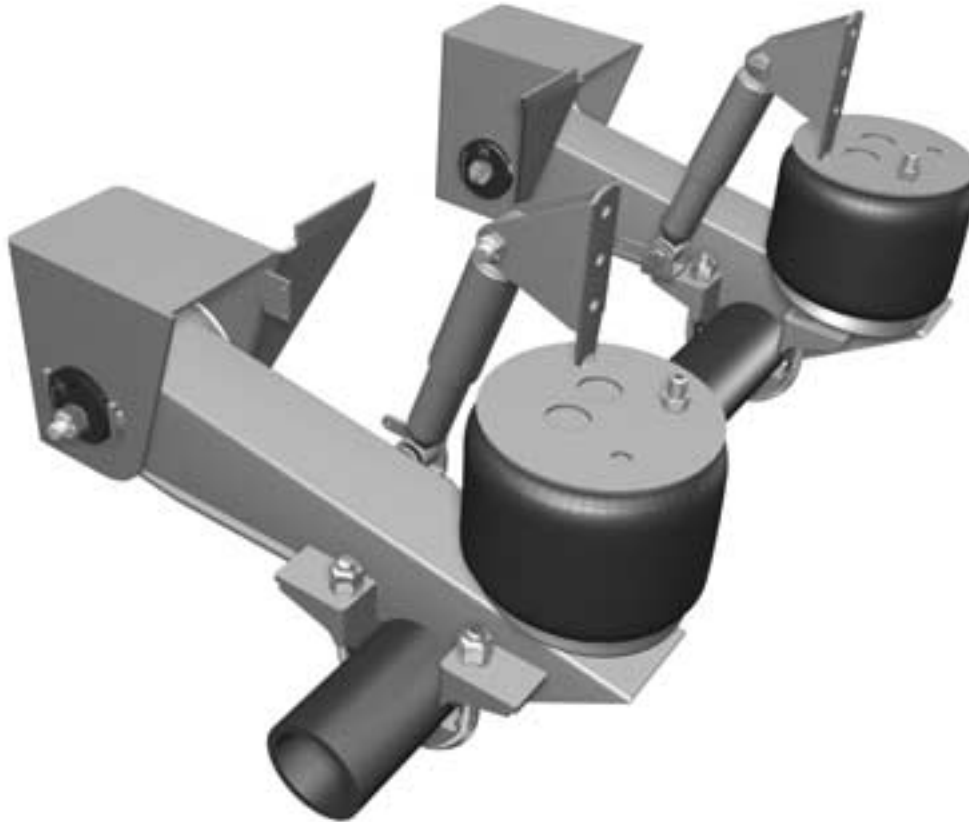

TABLE OF CONTENTS

PRIMARY APPLICATIONS	3
Model Chart — Weld-On	3
Model Chart — Bolt-On	3
Model Chart — Remote Shock	3
SLIDER APPLICATIONS — NON-HENDRICKSON	4
Model Chart — Complete Slider Suspensions	4
Model Chart — Slider Suspensions with Separate Frame Bracket Kit	5
LIFTABLE APPLICATIONS	6
Model Chart — Weld-On	6
Model Chart — Bolt-On	6
Lift Kit Chart	6

For The Road Ahead

H HENDRICKSON

PRIMARY APPLICATIONS

CAPACITY:	23,000 lbs (10 400 kg)	
TRAILER TYPES:	UNITED STATES AND CANADA Container Chassis Flat/Platform Grain Specialty	MEXICO, CENTRAL AND SOUTH AMERICA None
*AXLE DATA:	5-inch diameter round	
AXLE ARRANGEMENT:	Single; tandem: 122-inch maximum axle spacing Tri- or quad: 144-inch maximum total spacing	
FRAME TYPES:	Steel or aluminum; 96-inch or 102-inch wide trailers	

*Hendrickson recommends 0.625" nominal wall thickness.

MODEL CHART — WELD-ON

SUSPENSION MODEL NUMBER	RISE HEIGHT ¹ (inches)	JOUNCE (inches)	REBOUND (inches)	WEIGHT ² (pounds)
HT230TA14-001	14	2.9	5.1	302
HT230TA15-001	15	3.2	5.0	305
HT230TA16-001	16	3.0	4.8	317
HT230TA17-001	17	3.2	5.0	320

MODEL CHART — BOLT-ON

SUSPENSION MODEL NUMBER	RISE HEIGHT ¹ (inches)	JOUNCE (inches)	REBOUND (inches)	WEIGHT ² (pounds)
HT230TA14-002	14	2.8	5.1	338
HT230TA15-002	15	3.0	5.2	349
HT230TA16-002	16	2.9	5.1	360
HT230TA17-002	17	3.0	5.2	363

MODEL CHART — REMOTE SHOCK

SUSPENSION MODEL NUMBER	RISE HEIGHT ¹ (inches)	JOUNCE (inches)	REBOUND (inches)	WEIGHT ² (pounds)
HT230TA14-007	14	2.8	5.1	307
HT230TA15-007	15	3.2	5.0	306
HT230TA16-007	16	3.0	4.8	318
HT230TA17-007	17	3.2	5.0	321

¹15-inch and 17-inch rise heights are available with 4-inch jounce and 4-inch rebound.

²Weights shown do not include the axle or the frame bracket crossmember.

HT230 SPECIFICATIONS

SLIDER APPLICATIONS — NON-HENDRICKSON

CAPACITY:	23,000 lbs (10 400 kg)	
TRAILER TYPES:	UNITED STATES AND CANADA Van Reefer Specialty	MEXICO, CENTRAL AND SOUTH AMERICA None
*AXLE DATA:	5-inch diameter round	
AXLE ARRANGEMENT:	49-inch axle spacing standard (Other spacings accommodated)	
SLIDER TYPES:	96-inch or 102-inch wide trailers NOTE: For slider applications Hendrickson recommends our HK230 slider system. The following suspension models are for use in applications where another manufacturer's subframe is to be used. Contact Hendrickson Application's Engineering for review and approval of the subframe of your choice: Hutchens — 8300, 8900 and 11700 Series Binkley — SL-6154 and SL-1003 Models Others — van style subframes with body rails	

*Hendrickson recommends 0.625" nominal wall thickness.

MODEL CHART — COMPLETE SLIDER SUSPENSIONS

SUSPENSION MODEL NUMBER	RIDE HEIGHT (inches)	JOUNCE (inches)	REBOUND (inches)	WEIGHT ² (pounds)
HT230TA14-004	14	3.0	4.8	288
HT230TA15-009	15	3.2	4.9	298
HT230TB15-009	15	3.2	4.9	303
HT230TA16-004	16	3.0	4.8	310
HT230TB16-004	16	3.0	4.8	319
HT230TB17-009	17	3.2	4.9	322

²Weights shown do not include the axle or the frame bracket crossmember.

MODEL CHART — SLIDER SUSPENSIONS WITH SEPARATE FRAME BRACKET KIT

SUSPENSION MODEL NUMBER	RIDE HEIGHT (inches)	JOUNCE (inches)	REBOUND (inches)	WEIGHT ² (pounds)
HT230TB14-003 (SFK-081)	14	2.9	4.8	233 57
HT230TB15-010 (SFK-078)	15	3.2	4.9	233 70
HT230TB16-003 (SFK-085)	16	3.0	4.8	233 86
HT230TB17-010 (SFK-082)	17	3.2	4.9	233 89

²Weights shown do not include the axle or the frame bracket crossmember.

NOTE: Frame bracket kits are installed by the slider manufacturer of your choice. The bracket kits (SFK's) are shipped directly to the slider source. Freight charges are normally added to your slider invoice.

HT230 SPECIFICATIONS

LIFTABLE APPLICATIONS

CAPACITY:	23,000 lbs (10 400 kg)
TRAILER TYPES:	UNITED STATES ONLY Flat/Platform Specialty NOTE: Suspension has limited amount of travel available for liftable applications. Verify that the required amount of tire clearance can be achieved when specifying this product. Not recommended for use as liftable axle with leaf spring primary suspension. Not recommended for lift applications unless they are lifted with an empty trailer.
*AXLE DATA:	5-inch diameter round
AXLE ARRANGEMENT:	Single; tandem: 122-inch maximum axle spacing Tri- or quad: 144-inch maximum total spacing
FRAME TYPES:	Steel or aluminum; 96-inch or 102-inch wide trailers

*Hendrickson recommends 0.625" nominal wall thickness.

MODEL CHART — WELD-ON

SUSPENSION MODEL NUMBER	RIDE HEIGHT (inches)	JOUNCE ³ (inches)	REBOUND (inches)	WEIGHT ² (pounds)
HT230TB15-003	15	3.9	4.1	304
HT230TB17-003	17	4.0	4.0	326

MODEL CHART — BOLT-ON

SUSPENSION MODEL NUMBER	RIDE HEIGHT (inches)	JOUNCE ³ (inches)	REBOUND (inches)	WEIGHT ² (pounds)
HT230TA15-004	15	3.8	4.1	338

LIFT KIT CHART⁴

LIFT KIT	RIDE HEIGHT (inches)	TRAILER WIDTH (inches)	WEIGHT (pounds)
CL-100	15	96	125
CL-101	17	96	131
CL-102	15	102	135
CL-103	17	102	141

²Weights shown do not include the axle or the frame bracket crossmember.

³Jounce dimension indicates maximum axle up-travel. Actual ground clearance will vary depending upon trailer frame and tire deflection.

⁴Lift kits and air control kits are also required to make a complete liftable system. These items must be ordered separately for each suspension.

 **HENDRICKSON**
Trailer Suspension Systems

A Boler Company

2070 Industrial Place SE • Canton, Ohio 44707-2600 USA
Phone (330) 456-7288 • Fax (330) 456-0105

250 Chrysler Drive, Unit #3 • Brampton, Ontario L6S 6B6 CAN
Phone (905) 789-1030 • Fax (905) 789-1033

www.hendrickson-intl.com

Information contained in this literature was accurate at the time of publication. Product changes may have been made after the copyright date that are not reflected.

L29 Rev A January 2000 Printed in United States of America.

The Boler Company.
Copyright © 2000
Hendrickson Trailer
Suspension Systems
All Rights Reserved